

# A66 Northern Trans-Pennine Project

Scheme 06: Appleby to Brough

TR010062

## 5.16 Works Plans

APFP Regulations 5(2)(j)

Planning Act 2008

Infrastructure Planning (Applications: Prescribed Forms and  
Procedure) Regulations 2009

June 2022

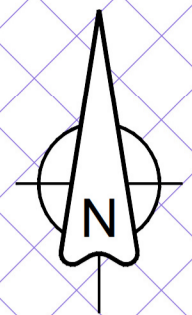
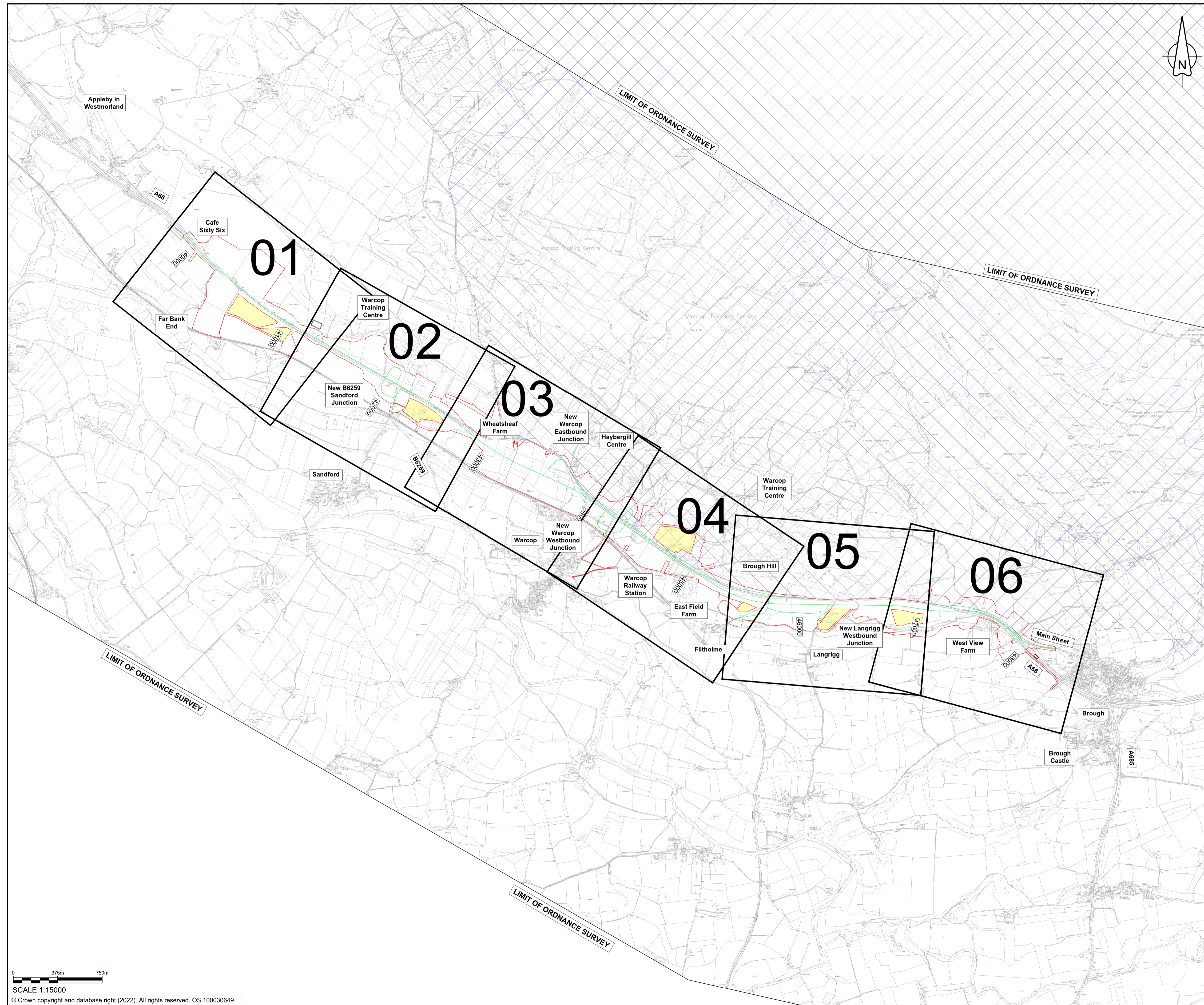

**NOTES**

1. ALL DIMENSIONS ARE IN METRES UNLESS NOTED OTHERWISE.

**KEY**

- ORDER LIMITS
- AREA EXCLUDED FROM ORDER LIMITS
- LINEAR WORK CENTERLINE
- 04 SHEET USED AS PART OF THIS DRAWING SERIES
- AREA OF OUTSTANDING NATURAL BEAUTY (AONB)
- CHAINAGE (MEASURED DISTANCE ALONG THE SCHEME LENGTH)

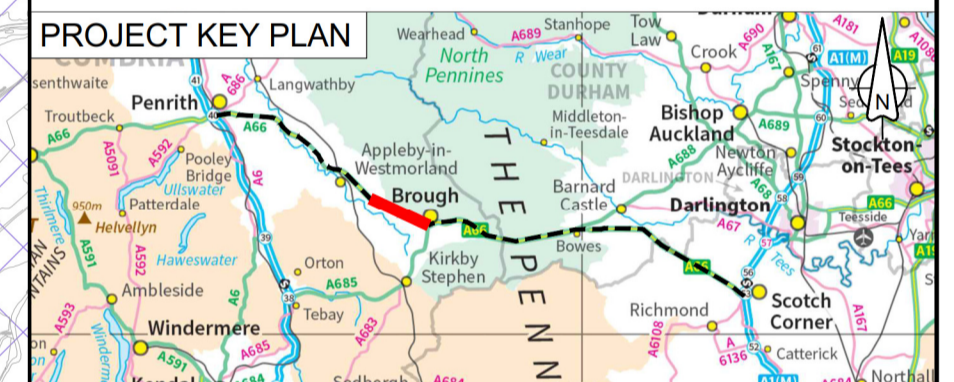

C01	For DCO Submission				
	MVAG	MVAG	PBUN	SBAG	SBAG
	26/05/22	26/05/22	06/06/22	06/06/22	06/06/22

Revision	Revision details				
	Created	Checked	Reviewed	Approved	Authorised
	dd/mm/yy	dd/mm/yy	dd/mm/yy	dd/mm/yy	dd/mm/yy

Purpose: DCO APPLICATION

PINS Reference Number: TR010062/APP/5.16

Client:  
3 Piccadilly Place  
Manchester  
M1 3BN

Project Name / Scheme Name:  
**A66 Northern Trans-Pennine Project  
Scheme 06  
Appleby to Brough**

Drawing Title:  
**Works Plans  
Regulation 5(2)(j)  
Key Plan**

Project Ref. No. ---	Stage PCF3	Scale: As Shown @ A1
		Dimensions: M

Drawing Number	Project	Originator	Volume
HE565627 - AMY - HAC -			
S06	-DR-CH-	401200	
Location	Type	Role	Number

Suitability	Suitability Description	Revision
A	Approved for Stage Complete	C01

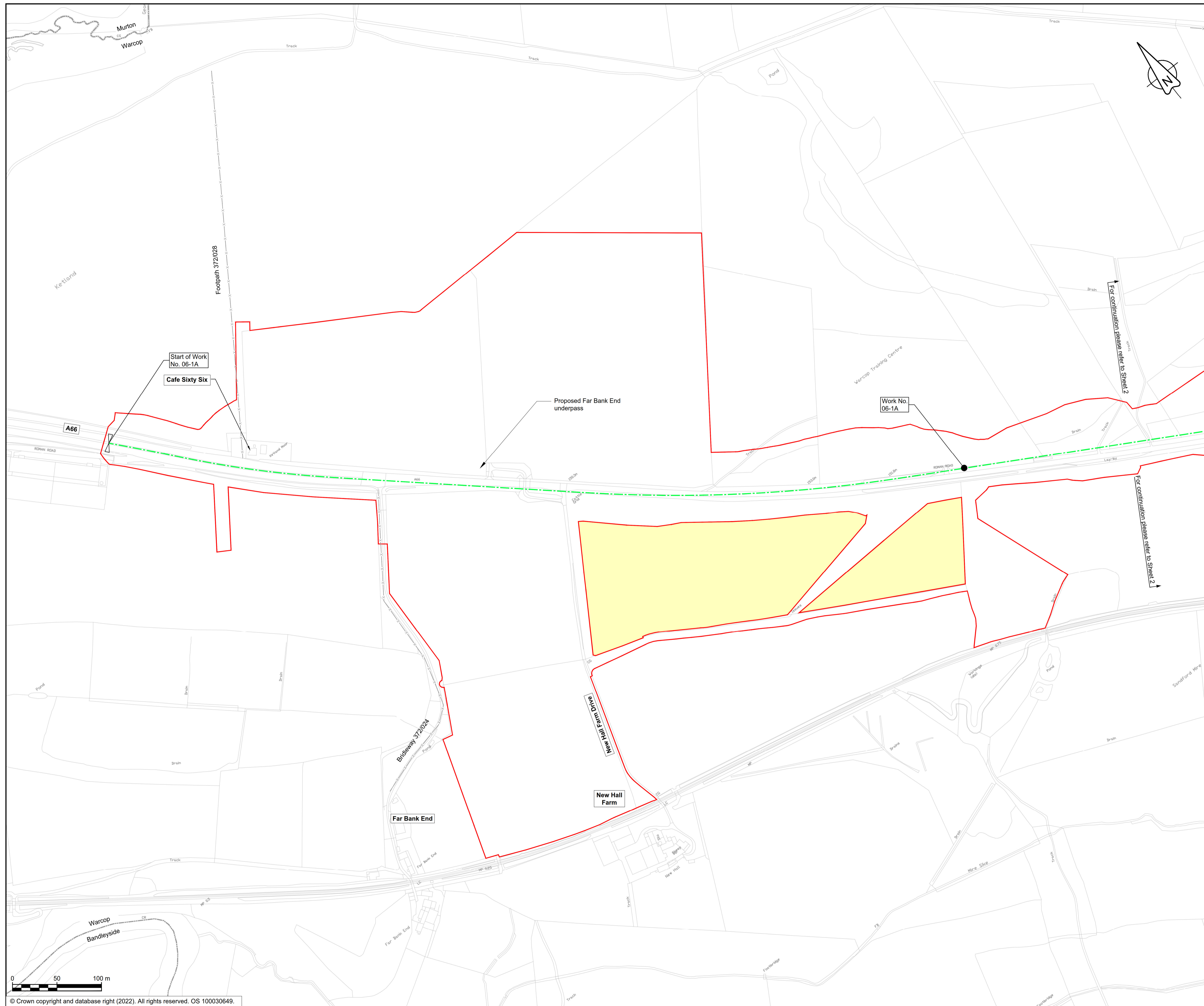

**NOTES**

1. ALL DIMENSIONS ARE IN METRES UNLESS NOTED OTHERWISE.
2. NUMBERED WORKS ARE DESCRIBED IN SCHEDULE 1 (AUTHORISED DEVELOPMENT) TO THE DEVELOPMENT CONSENT ORDER.
3. THE WORKS PLANS SHOULD BE READ IN CONJUNCTION WITH THE DEVELOPMENT CONSENT ORDER AND ENGINEERING SECTION DRAWINGS.

**KEY**

- ORDER LIMITS
- AREA EXCLUDED FROM ORDER LIMITS
- LINEAR WORK CENTERLINE
- LIMIT OF DEVIATION FOR LINEAR WORKS
- LIMIT OF DEVIATION FOR NON-LINEAR WORKS
- START OF LINEAR WORKS
- START AND END OF LINEAR WORKS
- END OF LINEAR WORKS
- EXISTING PUBLIC RIGHT OF WAY
- PARISH BOUNDARY
- AREA OF OUTSTANDING NATURAL BEAUTY (AONB)
- EXISTING ORDNANCE SURVEY



C02	For DCO Submission				
	MVAG	MVAG	PBUN	SBAG	SBAG
	08/06/22	08/06/22	08/06/22	08/06/22	08/06/22
Revision	Revision details				
	Created	Checked	Reviewed	Approved	Authorised
	dd/mm/yy	dd/mm/yy	dd/mm/yy	dd/mm/yy	dd/mm/yy

Purpose: DCO APPLICATION

PINS Reference Number: TR010062/APP/5.16

Client: 3 Piccadilly Place, Manchester, M1 3BN

Project Name / Scheme Name: A66 Northern Trans-Pennine Project Scheme 06 Appleby to Brough

Drawing Title: Works Plans Regulation 5(2)(j) Sheet 1 of 6

Project Ref. No.	Stage	Scale	@ A1
---	PCF3	1:2500	
		Dimensions	M

Drawing Number	Project	Originator	Volume
HE565627 - AMY - HAC -			
S06	-DR-CH-	401201	
Location	Type	Role	Number

Suitability	Suitability Description	Revision
A	Approved for Stage Complete	C02

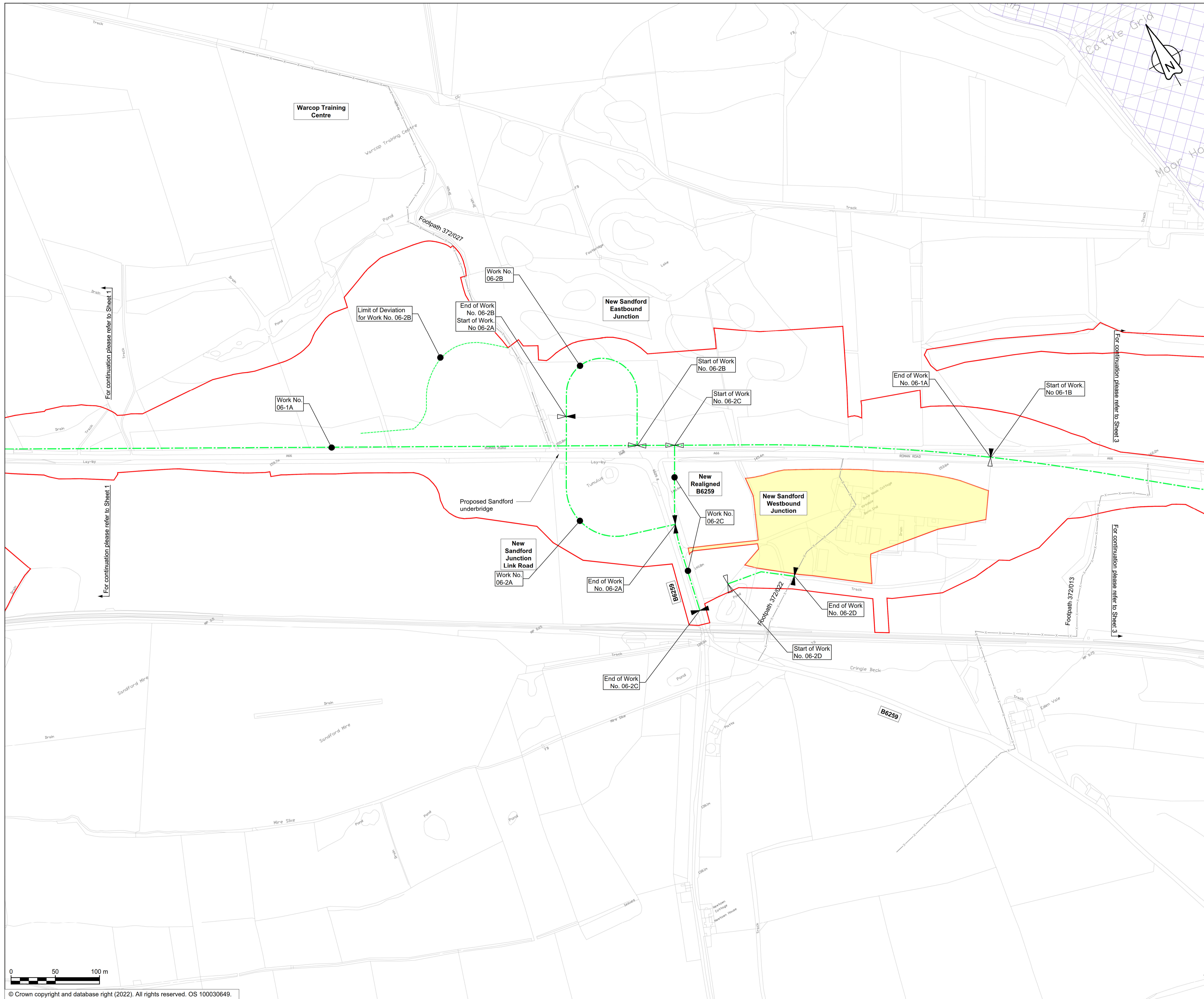

**NOTES**

1. ALL DIMENSIONS ARE IN METRES UNLESS NOTED OTHERWISE.
2. NUMBERED WORKS ARE DESCRIBED IN SCHEDULE 1 (AUTHORISED DEVELOPMENT) TO THE DEVELOPMENT CONSENT ORDER.
3. THE WORKS PLANS SHOULD BE READ IN CONJUNCTION WITH THE DEVELOPMENT CONSENT ORDER AND ENGINEERING SECTION DRAWINGS.

**KEY**

- ORDER LIMITS
- AREA EXCLUDED FROM ORDER LIMITS
- LINEAR WORK CENTERLINE
- LIMIT OF DEVIATION FOR LINEAR WORKS
- LIMIT OF DEVIATION FOR NON-LINEAR WORKS
- START OF LINEAR WORKS
- START AND END OF LINEAR WORKS
- END OF LINEAR WORKS
- EXISTING PUBLIC RIGHT OF WAY
- PARISH BOUNDARY
- AREA OF OUTSTANDING NATURAL BEAUTY (AONB)
- EXISTING ORDNANCE SURVEY

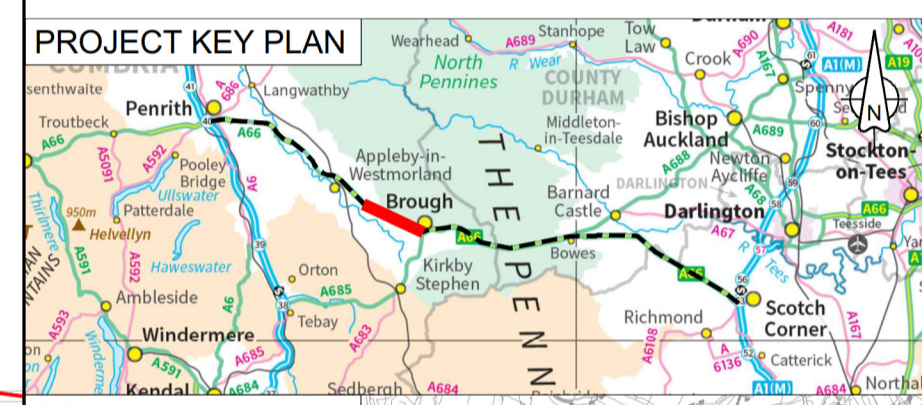

C01	For DCO Submission				
	VRAM	VRAM	PBUN	SBAG	SBAG
	11/05/22	11/05/22	06/06/22	06/06/22	06/06/22
Revision	Revision details				
	Created	Checked	Reviewed	Approved	Authorised
	dd/mm/yy	dd/mm/yy	dd/mm/yy	dd/mm/yy	dd/mm/yy

Purpose: DCO APPLICATION

PINS Reference Number: TR010062/APP/5.16

Client: 3 Piccadilly Place, Manchester, M1 3BN

Project Name / Scheme Name: A66 Northern Trans-Pennine Project Scheme 06 Appleby to Brough

Drawing Title: Works Plans Regulation 5(2)(j) Sheet 2 of 6

Project Ref. No.	Stage	Scale	@ A1
---	PCF3	1:2500	
		Dimensions	M

Drawing Number	Project	Originator	Volume
HE565627 - AMY - HAC -			
S06	-DR-CH- 401202		
Location	Type	Role	Number

Suitability	Suitability Description	Revision
A	Approved for Stage Complete	C01

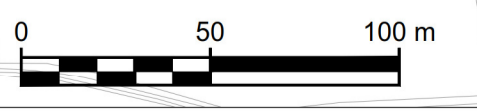

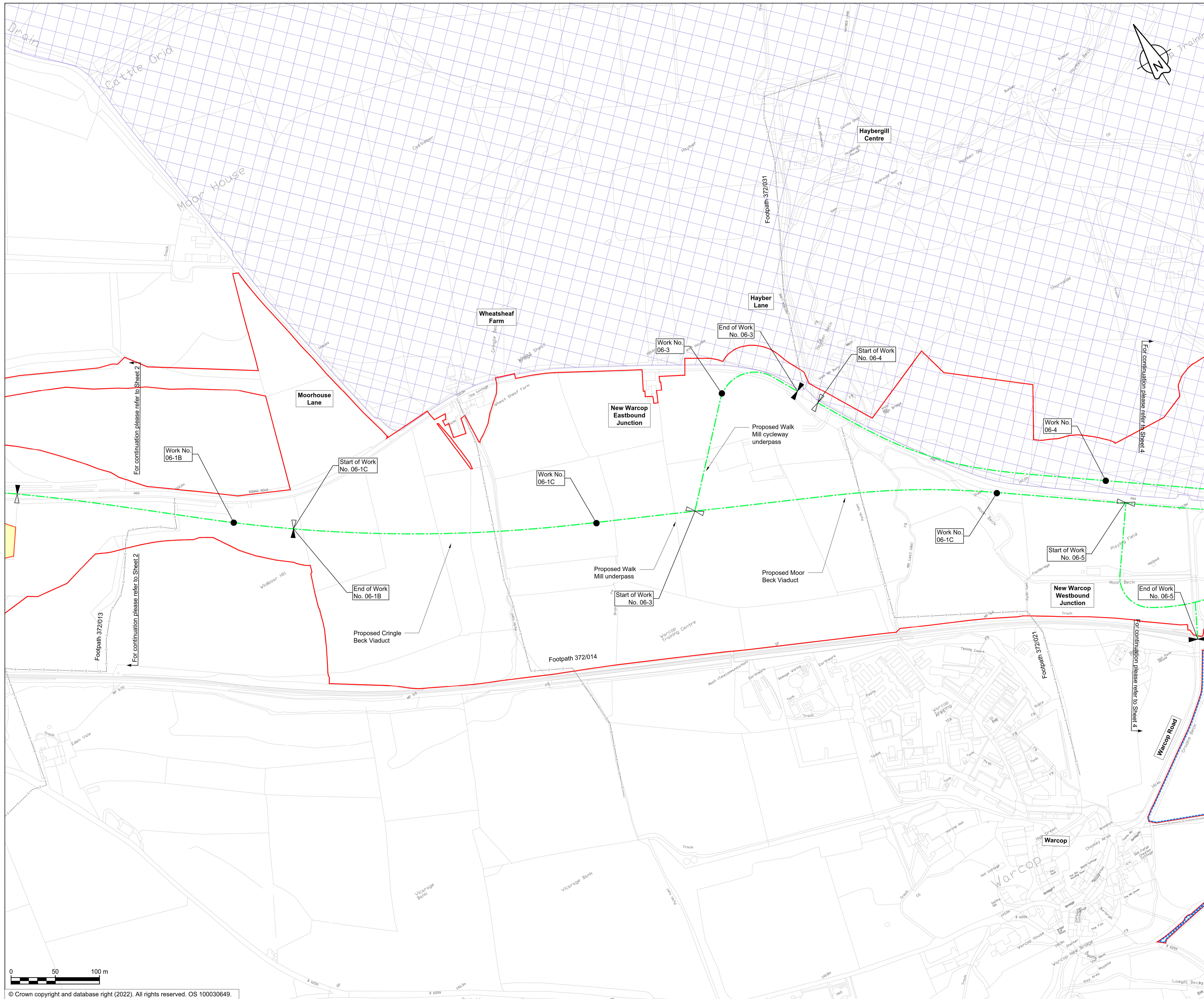

**NOTES**

1. ALL DIMENSIONS ARE IN METRES UNLESS NOTED OTHERWISE.
2. NUMBERED WORKS ARE DESCRIBED IN SCHEDULE 1 (AUTHORISED DEVELOPMENT) TO THE DEVELOPMENT CONSENT ORDER.
3. THE WORKS PLANS SHOULD BE READ IN CONJUNCTION WITH THE DEVELOPMENT CONSENT ORDER AND ENGINEERING SECTION DRAWINGS.

**KEY**

- ORDER LIMITS
- AREA EXCLUDED FROM ORDER LIMITS
- LINEAR WORK CENTERLINE
- LIMIT OF DEVIATION FOR LINEAR WORKS
- LIMIT OF DEVIATION FOR NON-LINEAR WORKS
- START OF LINEAR WORKS
- START AND END OF LINEAR WORKS
- END OF LINEAR WORKS
- EXISTING PUBLIC RIGHT OF WAY
- PARISH BOUNDARY
- AREA OF OUTSTANDING NATURAL BEAUTY (AONB)
- EXISTING ORDNANCE SURVEY

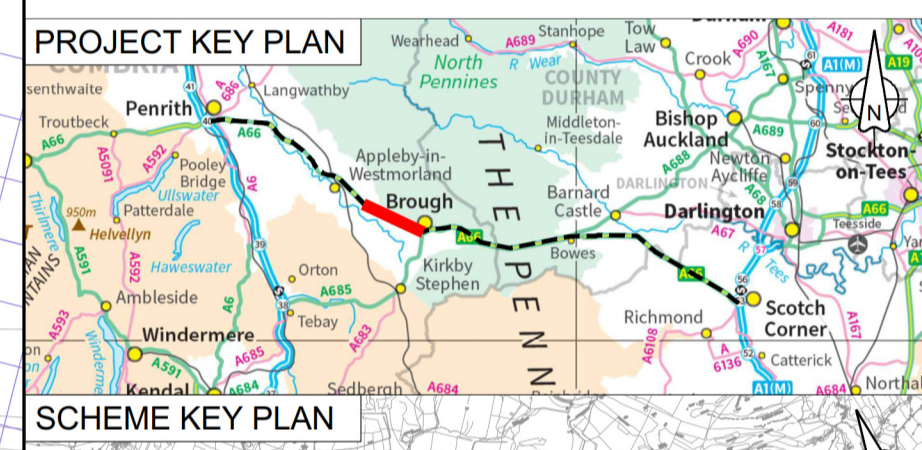

C01	For DCO Submission		VRAM	VRAM	PBUN	SBAG	SBAG
	12/05/22	12/05/22	06/06/22	06/06/22	06/06/22	06/06/22	06/06/22
Revision details							
Revision	Created	Checked	Reviewed	Approved	Authorised		
	dd/mm/yy	dd/mm/yy	dd/mm/yy	dd/mm/yy	dd/mm/yy		

Purpose: DCO APPLICATION

PINS Reference Number: TR010062/APP/5.16

Client: 3 Piccadilly Place, Manchester, M1 3BN



Project Name / Scheme Name: A66 Northern Trans-Pennine Project Scheme 06 Appleby to Brough

Drawing Title: Works Plans Regulation 5(2)(j) Sheet 3 of 6

Project Ref. No.	Stage	Scale:	@ A1
---	PCF3	1:2500	
		Dimensions:	M

Drawing Number	Project	Originator	Volume
HE565627 - AMY - HAC -			
S06	-DR-CH- 401203		
Location	Type	Role	Number

Suitability	Suitability Description	Revision
A	Approved for Stage Complete	C01

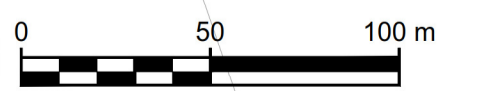

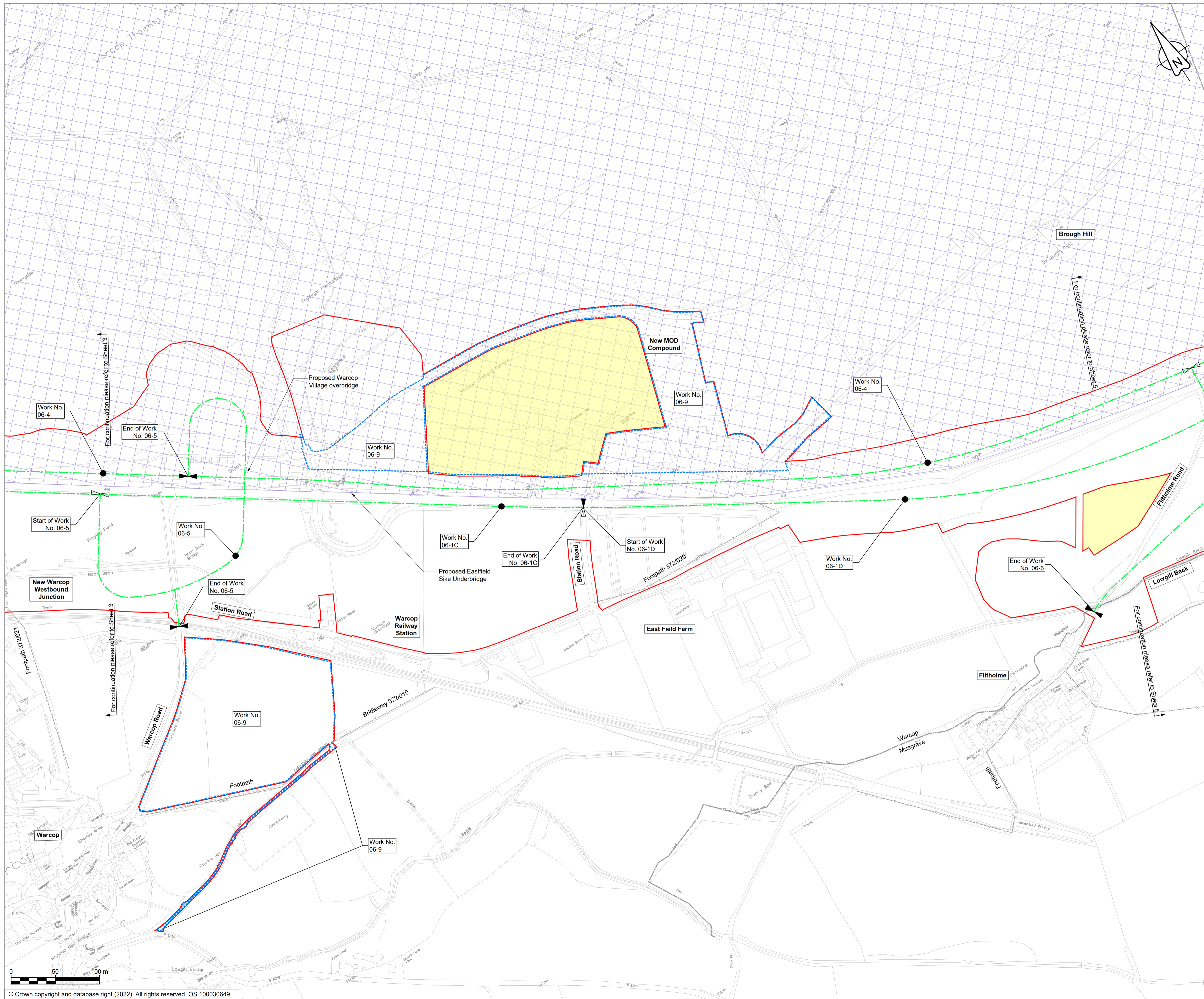

**NOTES**

1. ALL DIMENSIONS ARE IN METRES UNLESS NOTED OTHERWISE.
2. NUMBERED WORKS ARE DESCRIBED IN SCHEDULE 1 (AUTHORISED DEVELOPMENT) TO THE DEVELOPMENT CONSENT ORDER.
3. THE WORKS PLANS SHOULD BE READ IN CONJUNCTION WITH THE DEVELOPMENT CONSENT ORDER AND ENGINEERING SECTION DRAWINGS.

**KEY**

- ORDER LIMITS
- AREA EXCLUDED FROM ORDER LIMITS
- LINEAR WORK CENTERLINE
- LIMIT OF DEVIATION FOR LINEAR WORKS
- LIMIT OF DEVIATION FOR NON-LINEAR WORKS
- START OF LINEAR WORKS
- START AND END OF LINEAR WORKS
- END OF LINEAR WORKS
- EXISTING PUBLIC RIGHT OF WAY
- PARISH BOUNDARY
- AREA OF OUTSTANDING NATURAL BEAUTY (AONB)
- EXISTING ORDNANCE SURVEY

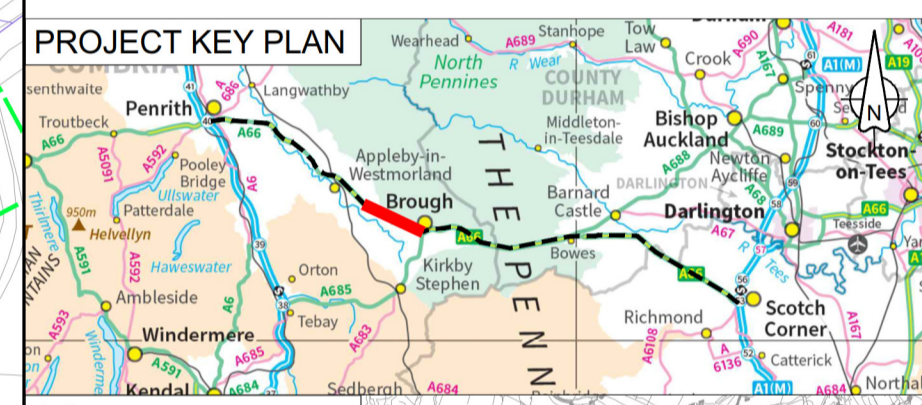

C01	For DCO Submission	VRAM	VRAM	PBUN	SBAG	SBAG
		12/05/22	12/05/22	06/06/22	06/06/22	06/06/22
Revision	Revision details	Created	Checked	Reviewed	Approved	Authorised
		dd/mm/yy	dd/mm/yy	dd/mm/yy	dd/mm/yy	dd/mm/yy

Purpose: **DCO APPLICATION**

PINS Reference Number: **TR010062/APP/5.16**

Client: **3 Piccadilly Place  
Manchester  
M1 3BN**



Project Name / Scheme Name: **A66 Northern Trans-Pennine Project  
Scheme 06  
Appleby to Brough**

Drawing Title: **Works Plans  
Regulation 5(2)(j)  
Sheet 4 of 6**

Project Ref. No.	Stage	Scale:	@ A1
---	PCF3	1:2500	
		Dimensions:	M

Drawing Number	Project	Originator	Volume
<b>HE565627 - AMY - HAC -</b>			
<b>S06</b>	<b>-DR-CH- 401204</b>		
Location	Type	Role	Number

Suitability	Suitability Description	Revision
<b>A</b>	<b>Approved for Stage Complete</b>	<b>C01</b>

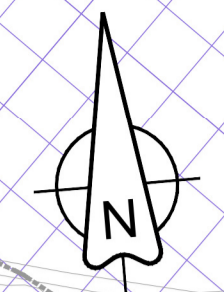
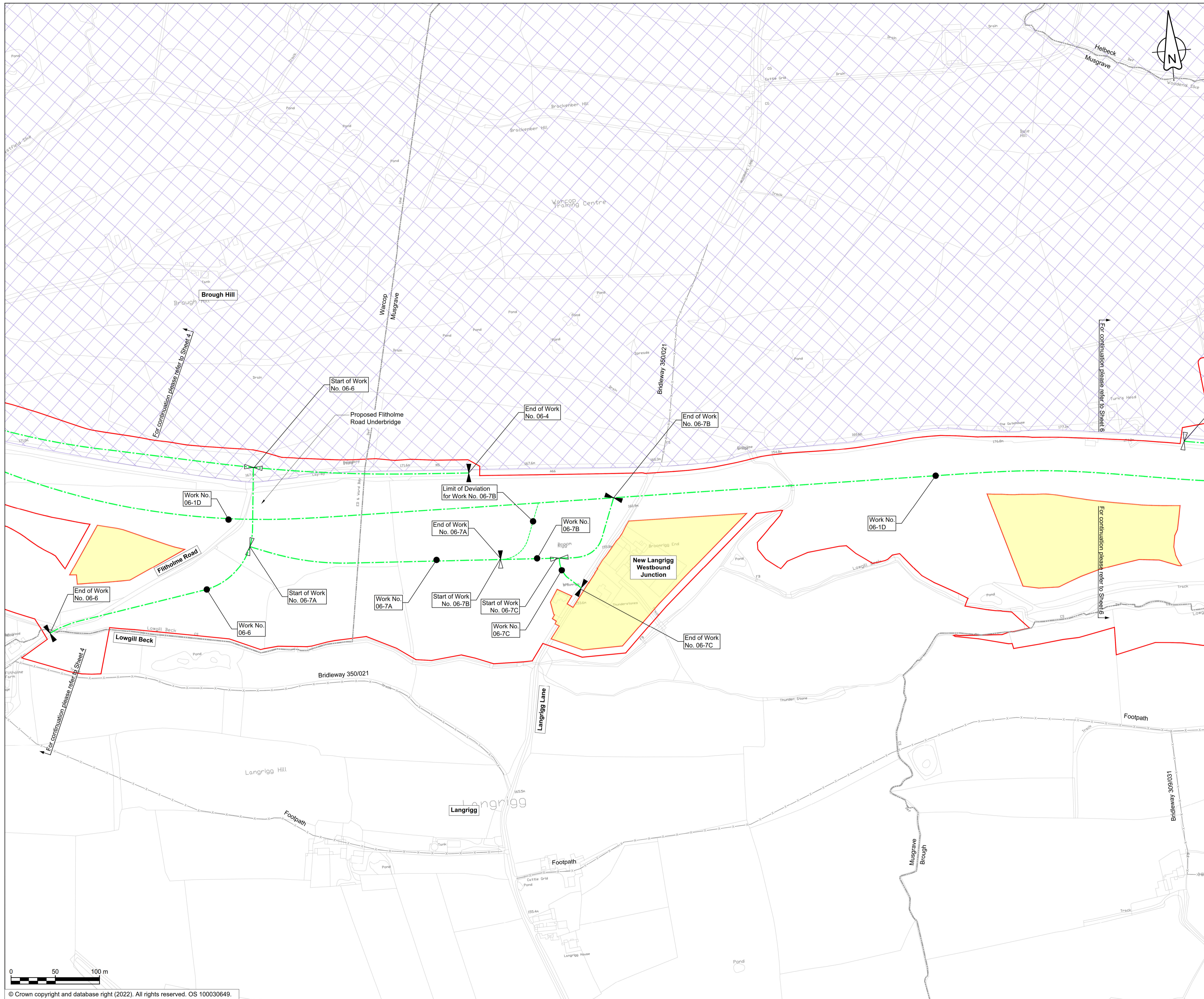

**NOTES**

1. ALL DIMENSIONS ARE IN METRES UNLESS NOTED OTHERWISE.
2. NUMBERED WORKS ARE DESCRIBED IN SCHEDULE 1 (AUTHORISED DEVELOPMENT) TO THE DEVELOPMENT CONSENT ORDER.
3. THE WORKS PLANS SHOULD BE READ IN CONJUNCTION WITH THE DEVELOPMENT CONSENT ORDER AND ENGINEERING SECTION DRAWINGS.

**KEY**

- ORDER LIMITS
- AREA EXCLUDED FROM ORDER LIMITS
- LINEAR WORK CENTERLINE
- LIMIT OF DEVIATION FOR LINEAR WORKS
- LIMIT OF DEVIATION FOR NON-LINEAR WORKS
- START OF LINEAR WORKS
- START AND END OF LINEAR WORKS
- END OF LINEAR WORKS
- EXISTING PUBLIC RIGHT OF WAY
- PARISH BOUNDARY
- AREA OF OUTSTANDING NATURAL BEAUTY (AONB)
- EXISTING ORDNANCE SURVEY



C01	For DCO Submission				
	VRAM	VRAM	PBUN	SBAG	SBAG
	12/05/22	12/05/22	06/06/22	06/06/22	06/06/22
Revision	Revision details				
	Created	Checked	Reviewed	Approved	Authorised
	dd/mm/yy	dd/mm/yy	dd/mm/yy	dd/mm/yy	dd/mm/yy

Purpose: DCO APPLICATION

PINS Reference Number: TR010062/APP/5.16

Client: 3 Piccadilly Place, Manchester, M1 3BN



Project Name / Scheme Name: A66 Northern Trans-Pennine Project, Scheme 06, Appleby to Brough

Drawing Title: Works Plans, Regulation 5(2)(j), Sheet 5 of 6

Project Ref. No.	Stage	Scale:	@ A1
---	PCF3	1:2500	
		Dimensions:	M

Drawing Number	Project	Originator	Volume
HE565627	- AMY	- HAC	-
S06	-DR-CH-	401205	
Location	Type	Role	Number

Suitability	Suitability Description	Revision
A	Approved for Stage Complete	C01

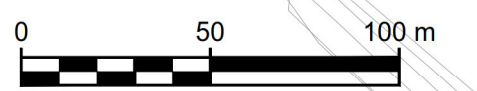

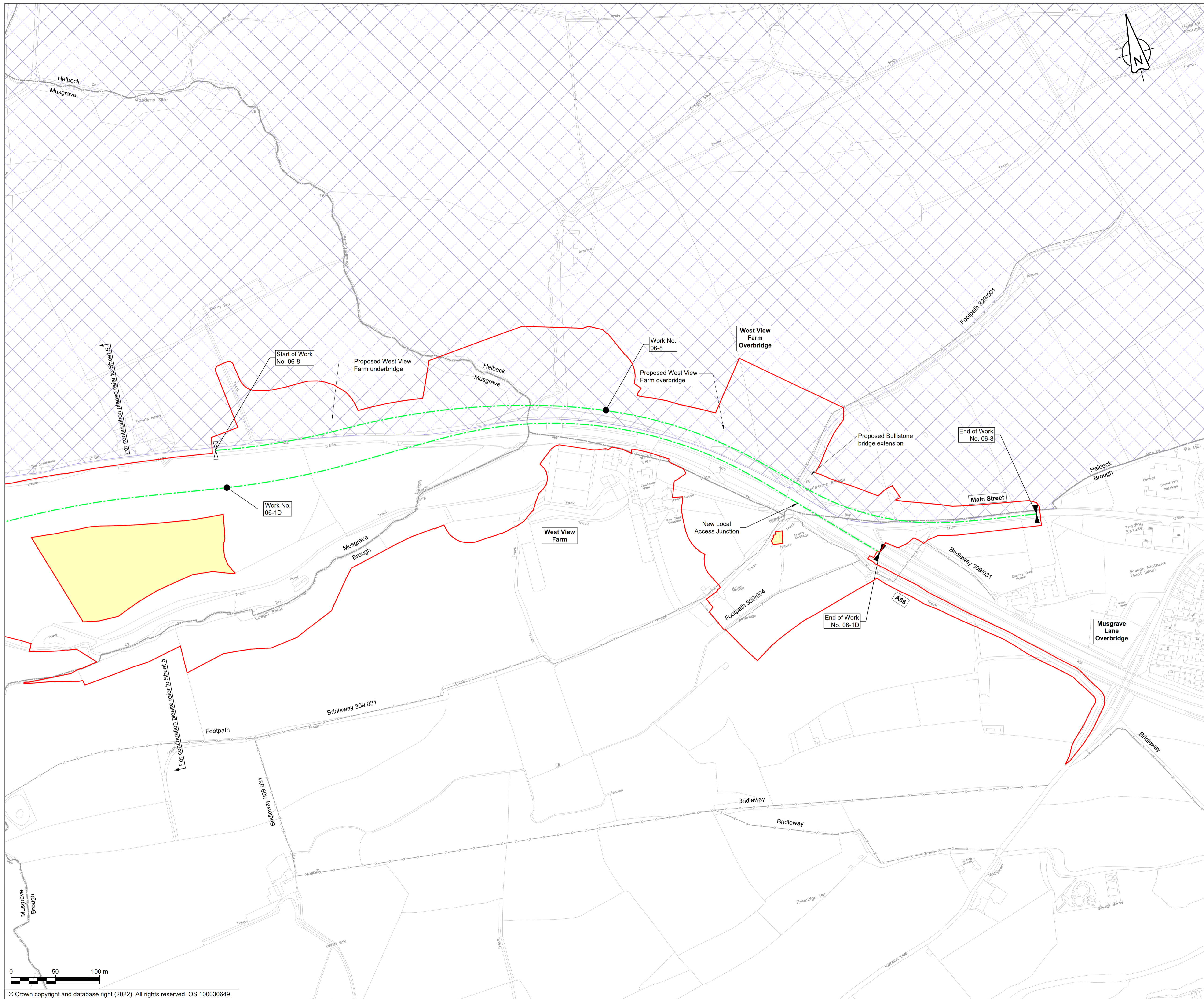

**NOTES**

1. ALL DIMENSIONS ARE IN METRES UNLESS NOTED OTHERWISE.
2. NUMBERED WORKS ARE DESCRIBED IN SCHEDULE 1 (AUTHORISED DEVELOPMENT) TO THE DEVELOPMENT CONSENT ORDER.
3. THE WORKS PLANS SHOULD BE READ IN CONJUNCTION WITH THE DEVELOPMENT CONSENT ORDER AND ENGINEERING SECTION DRAWINGS.

**KEY**

- ORDER LIMITS
- AREA EXCLUDED FROM ORDER LIMITS
- LINEAR WORK CENTERLINE
- LIMIT OF DEVIATION FOR LINEAR WORKS
- LIMIT OF DEVIATION FOR NON-LINEAR WORKS
- START OF LINEAR WORKS
- START AND END OF LINEAR WORKS
- END OF LINEAR WORKS
- EXISTING PUBLIC RIGHT OF WAY
- PARISH BOUNDARY
- AREA OF OUTSTANDING NATURAL BEAUTY (AONB)
- EXISTING ORDNANCE SURVEY

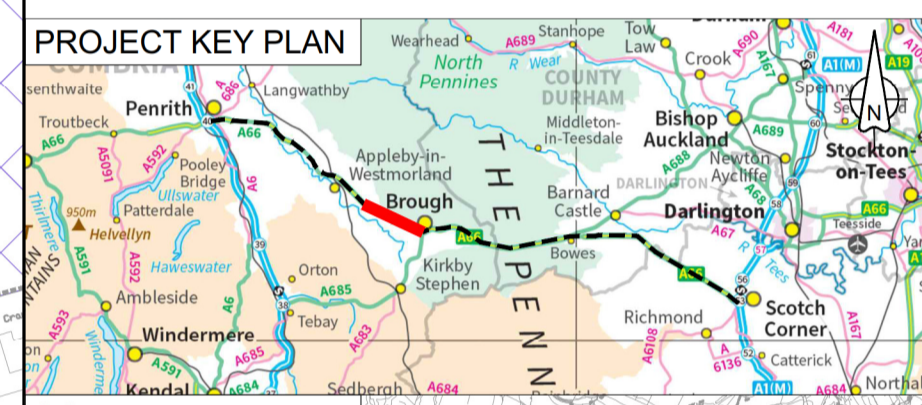

C01	For DCO Submission				
	MVAG	MVAG	PBUN	SBAG	SBAG
	26/05/22	26/05/22	06/06/22	06/06/22	06/06/22
Revision	Revision details				
	Created	Checked	Reviewed	Approved	Authorised
	dd/mm/yy	dd/mm/yy	dd/mm/yy	dd/mm/yy	dd/mm/yy

Purpose: DCO APPLICATION

PINS Reference Number: TR010062/APP/5.16

Client: 3 Piccadilly Place, Manchester, M1 3BN



Project Name / Scheme Name: A66 Northern Trans-Pennine Project Scheme 06 Appleby to Brough

Drawing Title: Works Plans Regulation 5(2)(j) Sheet 6 of 6

Project Ref. No.	Stage	Scale	@ A1
---	PCF3	1:2500	
		Dimensions	M

Drawing Number	Project	Originator	Volume
HE565627	- AMY	- HAC	-
S06	-DR-CH-	401206	
Location	Type	Role	Number

Suitability	Suitability Description	Revision
A	Approved for Stage Complete	C01

